

■ Note: When specifying/ordering grates, refer to "Choosing the Proper Inlet Grate" on pages 125-126.
 For a complete listing of FREE OPEN AREAS and WEIR PERIMETERS of all NEENAH grates, refer to pages 327-332.

R-3292 Combination Inlet Frame, Grate, Curb Box

Heavy Duty

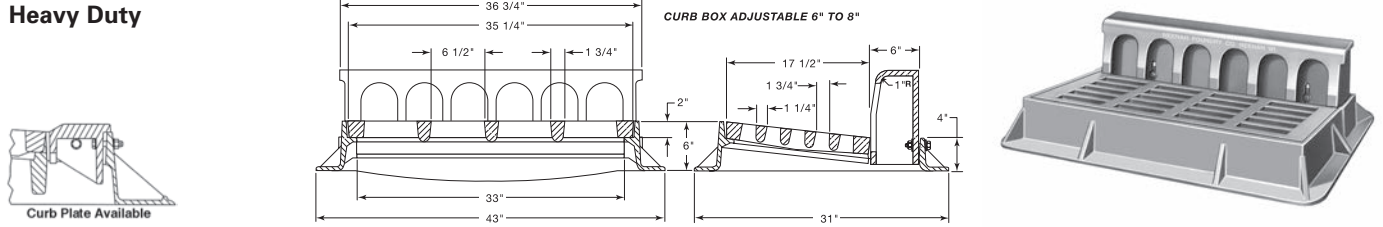

CATALOG NUMBER	GRATE TYPE	SQ. FT. OPEN	WEIR PERIMETER LINEAL FEET
R-3292	C	1.6	5.8

Available with mountable grated or solid curb plate in place of curb box.

COMBINATION INLETS
3

R-3293-2 Double Unit Frame, Grate, Curb Box

NEW

Heavy Duty

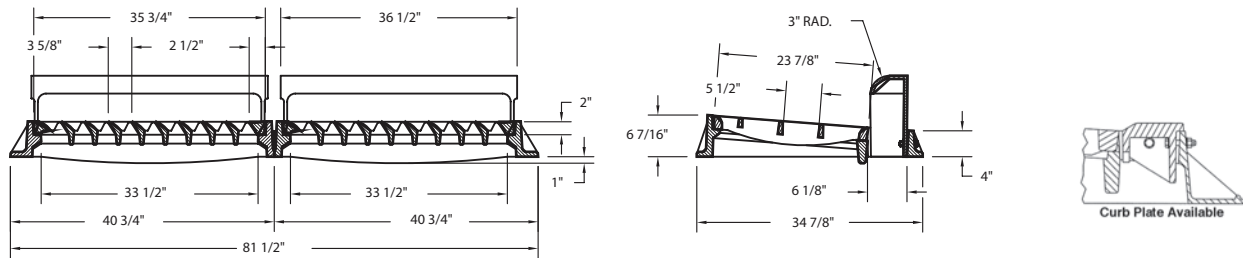

CATALOG NUMBER	GRATE TYPE	SQ. FT. OPEN	WEIR PERIMETER LINEAL FEET
R-3293-2	L	6.2	10.0
R-3293-2	C	4.4	10.0
R-3293-2	R	5.4	10.0

Standard Grate (shown): Type L
 Also available with grate Type C or Type R-diagonal.



Available curb boxes: 2" radius (standard) and square
 Enviro-curb boxes available, see p. 129.
 For single unit refer to R-3246-AL and R-3246-A. Order R-3246-ALP for curb plate.

